

GLAZED-IN VENTILATORS

THK60: flapvent with external hood for good weather protection
AR60: self-regulating flapvent with external hood for good weather protection

THK60 • AR60

INTRODUCTION

The THK60 and AR60 are thermally broken, slimline glazed-in ventilators, for application in aluminium, timber and uPVC windows. The perforated inside grille performs as an insect mesh. The internal tip directs the flow of incoming air upwards, and can be placed in 5 positions due to a clip. This clip can be replaced if necessary to ensure the longterm life-expectancy of the ventilator. The first position allows for trickle ventilation, but can be closed with a positive closing click against a rubber strip to ensure windtightness.

The AR60 has an automatically operating flap in the ventilator maintaining a constant airflow in the living-area, independent of the windforce.

MATERIAL

Inside and outside profile: aluminium AlMgSi 0.5 (according to DIN 1748)

Finishing: satin anodised or powdercoated in any RAL or Syntha Pulvin® colour (dual colour possible)

Endcaps in ASA polymer type Luran S (colourfast, weather- and UV-resistant)

Endcaps are in black or white but also available in other colours upon request.

DIMENSIONS

Glass reduction: 60 mm

Height: 76 mm

Glass thickness: 20, 24 & 28 mm

CONTROLS

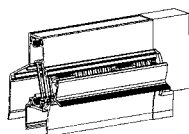

manual control

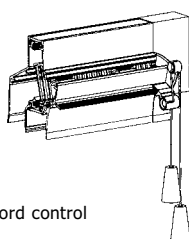

cord control

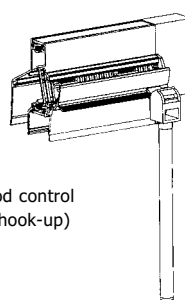

rod control
(hook-up)



ASSEMBLY

Developed for fabrication from bar lengths (6000 mm) or made to measure (maximum 2500 mm)

Cut ventilator to size from a bar length, fix endcaps (1 L + 1 R)

We advise use of glazing gasket RENSON nr 039 or nr 034 (20-28 mm) for installation

Overall dimension of the ventilator (T) = extrusion length (Z) + (2 x endcaps (EC))

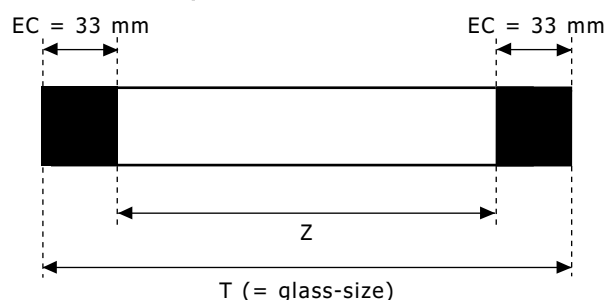

SECTION DETAILS

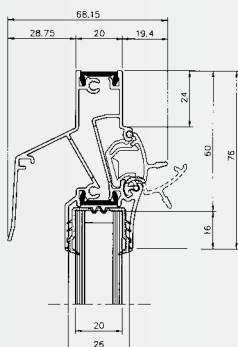

THK60

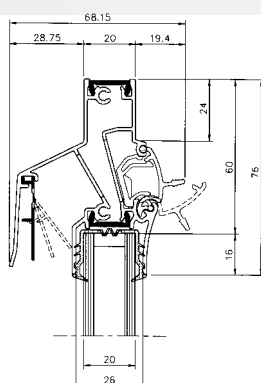
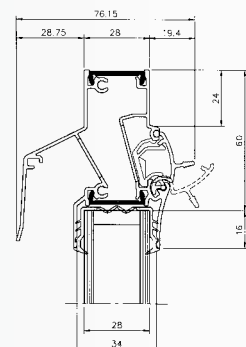
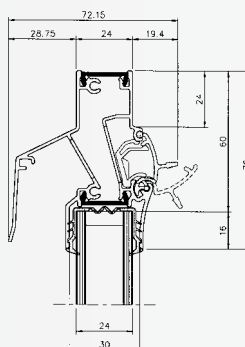

AR60

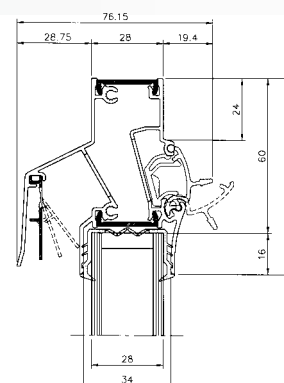
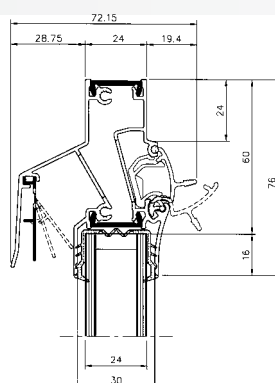

TECHNICAL SPECIFICATIONS

| | THK60 | AR60 |
|---|-------------------------------|--------------------------|
| AIRFLOW | | |
| 2 Pa | 47,5 m ³ /h/m | 42,3 m ³ /h/m |
| 2 Pa | 13,2 l/s/m | 11,8 l/s/m |
| 1 Pa | 9,3 l/s/m | 8,2 l/s/m |
| Equivalent area | 11841 mm ² /m | 10427 mm ² /m |
| COMFORT | | |
| Sound reduction D _{n,e,w} (C;C _{tr}) | (EN ISO 140-10, EN ISO 717-1) | |
| - in open position | 27 (0;0) dB | |
| - in closed position | 44 (0;0) dB | |
| Self regulating | no | yes |
| TECHNICAL CHARACTERISTICS | | |
| U-value | 4,5 W/m ² K | |
| Watertightness (closed position) | 650 Pa | |
| Windtightness | 650 Pa | |