

VEGA

Chain actuator - Force in push action 250 N - Maximum stroke 300 mm

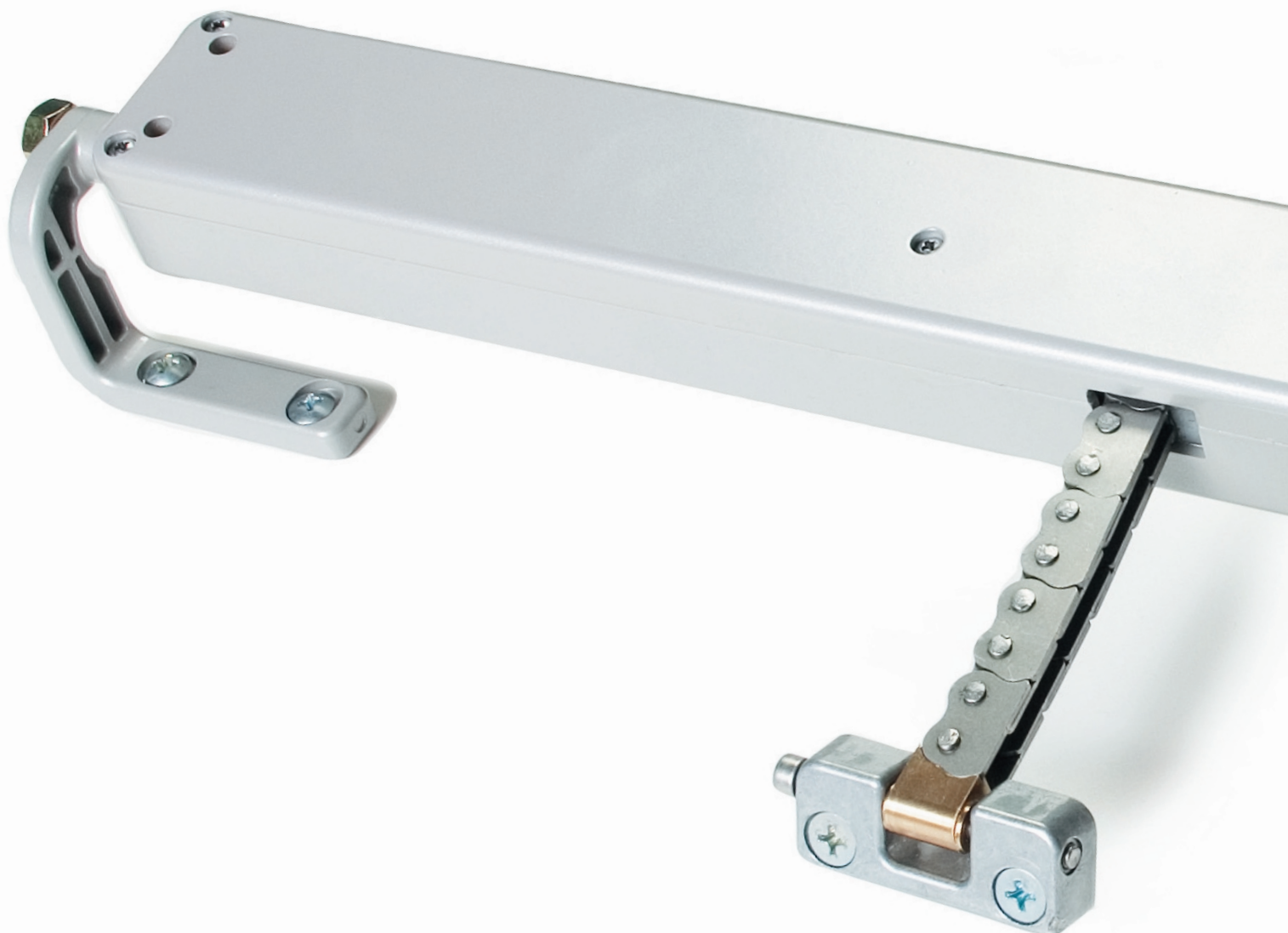

PATENTED CHAIN ACTUATOR

- Highest performance in minimum size: the die-cast aluminium casing has a very small section (45 x 32 mm) and can be easily built-in into the frame of curtain walls.
- New concept double link chain completely in stainless steel.
- Chain exit in central position.
- Quick and easy installation: the manual closing position regulation is not required, avoiding possible mistake. The stop in closing position is regulated by an electronic limit switch.
- If installed on PVC windows, the profile has to be reinforced.
- Electronic stop in the intermediate positions in case of overload.
- Supplied with 1,5 m cable and pivoting brackets.
- The installation without brackets is possible for windows with pivoting hinges only if the vent height is at least 900 mm.
- Available on request a coupling control box for two actuators 24 Vdc on the same window.



	VEGA AC	VEGA DC	VEGA RF
VOLTAGE SUPPLY	100 Vac - 240 Vac	24 Vdc \pm 10%	100 Vac - 240 Vac
ELECTRIC CONNECTION	3 wires + earth	2 wires (by polarity inversion)	4 wires + earth
STROKE	300 mm	300 mm	300 mm
FORCE (push and pull action)	250 N	250 N	250 N
SPEED	~ 9 mm/s	~ 9 mm/s	~ 9 mm/s
CURRENT ABSORPTION (with max load)	0,3 A - 0,15 A	0,7 A	0,3 A - 0,15 A
PARALLEL CONNECTION	YES	YES	YES
LIMIT STOP	Electronic	Electronic	Electronic
SAFETY STOP	Electronic	Electronic	Electronic
TIME RATING	50%	50%	50%
PROTECTION CLASS	IP 30	IP 30	IP 30
			Integrated RF RECEIVER Available, upon request, version with direct connection to rain sensor
PART No.			
GREY RAL 9006	40900K	40903N	40906Q
BLACK RAL 9005	40901L	40904O	40907R
WHITE RAL 9010	40902M	40905P	40908S

VEGA

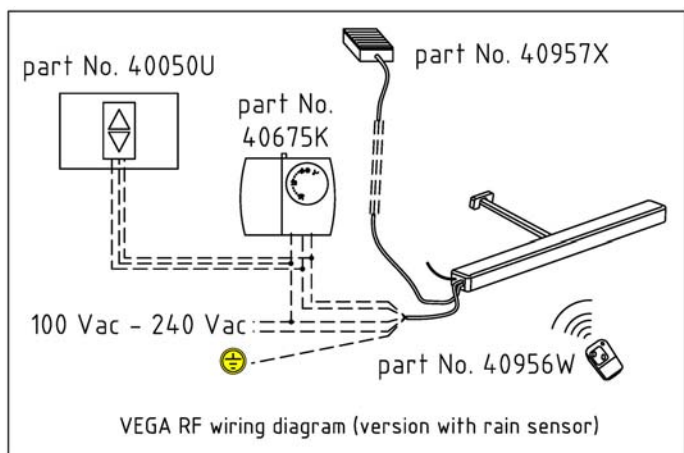

VEGA RF

The VEGA RF model is controlled by a radio transmitter (frequency 433,92) and is predisposed for the direct connection at a thermostat without any control panel. Available VEGA RF version with direct connection to a rain sensor. The thermostat and the rain sensor must be ordered separately.

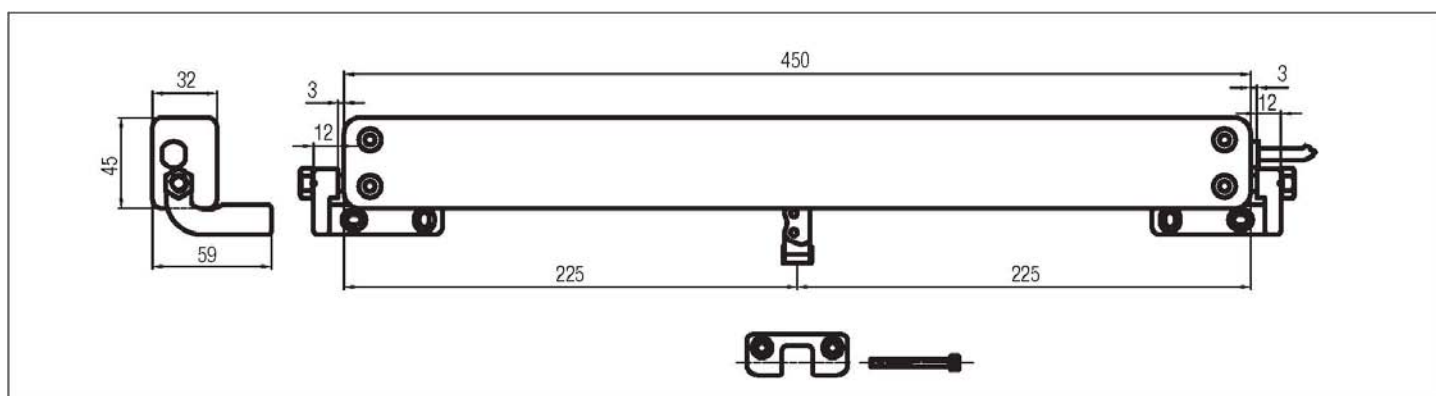

Actuator dimensions

SPECIFICATION PROSPECTS

Electric chain actuator Ultraflex Control Systems named Vega with double link chain completely in stainless steel. Voltage supply: from 100 to 240 Vac or 24 Vdc - Electronic limit stop; electronic stop in the intermediate positions in case of overload.

Casing in painted die-cast aluminium with very small section (45x32 mm).

Pivoting brackets included.

The 100-240 Vac version and the 24 Vdc version are conform to 89/336 EMC directives as modified per 93/68 CE, the 100-240 Vac version is conform to 73/23 LVD directives.

⚠ The instructions for a safe installation are included in the section "SECURITY WARNINGS"

Installation examples

green line



Top hinged windows

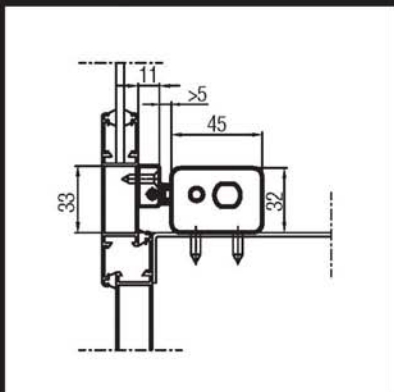

On windows with windowsill

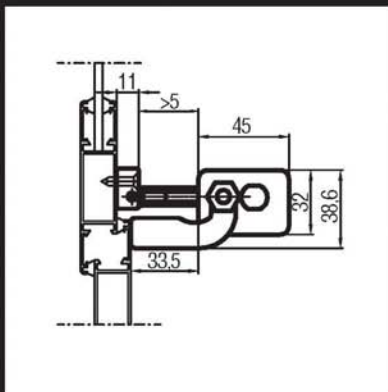

On windows without windowsill with pivoting brackets kit included

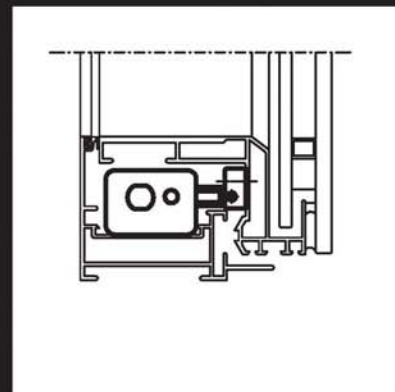

Inside a curtain wall frame



Top hinged roof windows



Bottom hinged windows

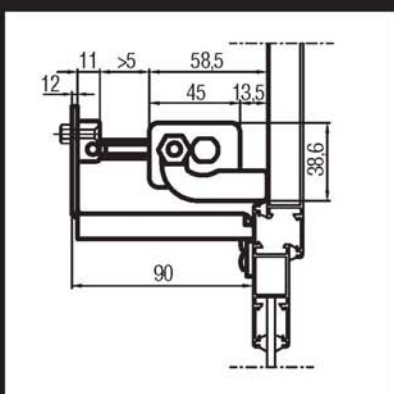

On the frame with pivoting brackets kit and bracket for bottom hinged windows part No. 40858U

Accessori

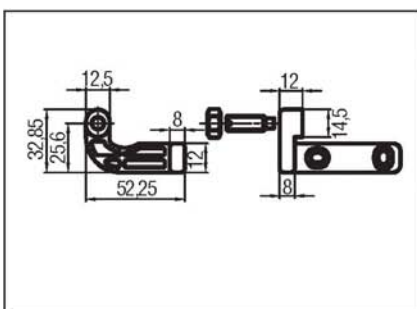

Pivoting brackets kit (included)

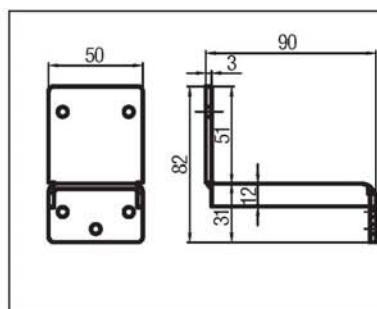

Bracket for bottom hinged windows part No. 40858U



Radio-transmitter for VEGA RF – part No. 40956W

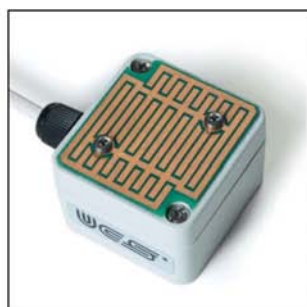

Rain sensor for VEGA RF part No. 40957X



Thermostat part No. 40675K

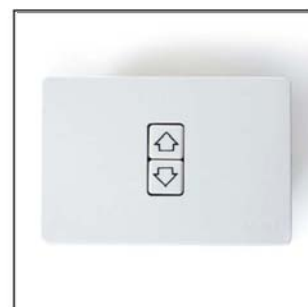

Flush mount double push button part No. 40050V